



Plan Information

- 2,722 SqFt
- 3 Bedrooms
- 3 Baths
- 2 Car Garage
- Low Step Entry Easy Access Living
- Mud Room w/Bench, Closet, Laundry Access
- Foyer, Dining, Owners Suite w/Tray Ceilings
- 12' Ceiling Great Room
- 10' Ceilings, 8' Doors on 1st Floor
- Kitchen w/Walk-in Pantry & Pocket Office
- 1st Flr Bedroom/Library w/Murphy Bed
- Rear Covered Veranda
- Owners Suite w/Huge Bath, Oversize Shower
- Spacious Wardrobe w/Door to Laundry
- 2nd Floor w/Loft, Bedroom, Full Bath, Storage

Home Information

This custom patio home features low step entry, easy access living a 12' ceiling great room, and 1st flr 10' ceilings and 8' doors. The kitchen has a walk-in pantry and pocket office. The spacious dining area includes a box tray ceiling. The owners suite includes a box tray ceiling, oversized shower and a large wardrobe w/laundry access door. A 1st flr guest bedroom/library w/murphy bed, a mud entry w/bench, closet & laundry access, a rear covered veranda, and a second floor w/large loft, bedroom, full bath & extra storage, complete this beautiful home.

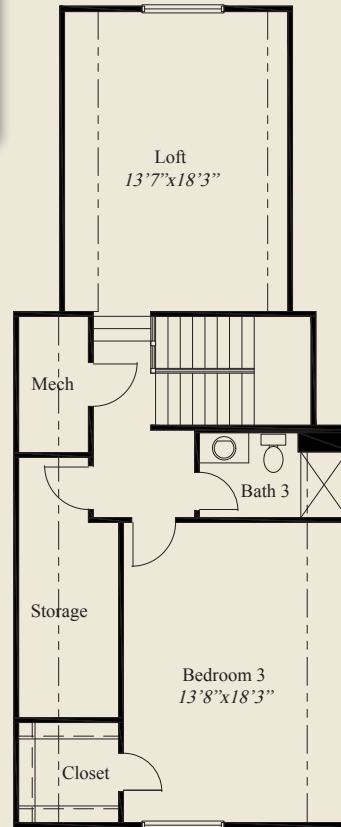

SECOND FLOOR 895 SQ.FT.



FIRST FLOOR 1,827 SQ.FT.

© Romanelli & Hughes Building Co.
 All home plans present on this brochure are protected by copyright. Reproduction either in whole or in part without written permission is strictly prohibited. All renderings and floor plans are artists' conceptions and are not intended to be an actual depiction of the home or its surroundings.

