



- ### Plan Information
- 3,432 SqFt
  - 3 Bedrooms
  - 3 1/2 Baths
  - 2 Car Garage
  - 10' Ceilings, 8' Doors on First Floor
  - Great Room w/ 12' Box Beam Ceiling
  - Large Kitchen w/ Chefs Pantry and Pocket Office
  - Tray Ceilings in the Dining, Foyer and Owners Suite
  - Owners Bath w/ Seated Shower and 11' Ceiling
  - Laundry w/ Opt. Wardrobe Access
  - First Floor Guest Suite w/ Private Bath
  - Private Library w/ Built-ins
  - Covered Rear Veranda
  - Finished LL w/ Family Room, Bedroom, Bath

### Home Information

This custom home features a 12' box beam ceiling in the great room and 10' ceilings and 8' doors on the first floor. Tray ceilings adorn the dining area, foyer and owners suite. The owners suite includes a large wardrobe w/ opt. access to the laundry. The owners bath has an 11' ceiling and oversized shower. A private library w/ built-ins, large kitchen w/ chefs pantry and pocket office, covered veranda, a 1st floor guest suite w/ private bath and switch back stairs to the finished lower level with family room and third bedroom, all add to the appeal of this beautiful home.

© Romanelli & Hughes Building Co. All home plans present on this brochure are protected by copyright. Reproduction either in whole or in part without written permission is strictly prohibited. All renderings and floor plans are artists' conceptions and are not intended to be an actual depiction of the home or its surroundings.

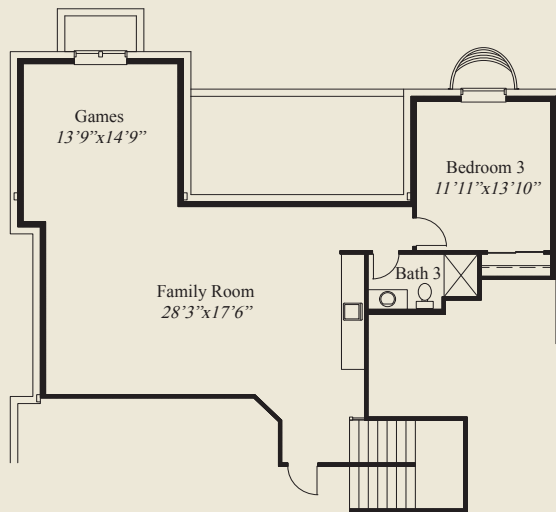

LOWER LEVEL 1,052 SQ.FT.



FIRST FLOOR 2,380 SQ.FT.

